

Permit

The Environmental Permitting (England & Wales) Regulations 2010

Frimstone Limited

Carbrooke Quarry
Summer Lane
Carbrooke
Thetford
Norfolk
IP25 6TJ

Permit number

EPR/RP3898VC

Permit

The Environmental Permitting (England and Wales) Regulations 2010

Permit

Permit number

EPR/RP3898VC

The Environment Agency hereby authorises, under regulation 13 of the Environmental Permitting (England and Wales) Regulations 2010

Frimstone Limited ("the operator"),

whose registered office is

Ashcraft Farm

Main Road

Crimplesham

King's Lynn

Norfolk

PE33 9EB

company registration number 01232146

to operate waste operations described in standard rules **SR2010No12** at

Carbrooke Quarry

Summer Lane

Carbrooke

Thetford

Norfolk

IP25 6TJ

to the extent authorised by and subject to the conditions of this permit.

Under regulation 27(2) of the Regulations, standard rules **SR2010No12** are conditions of this permit.

Name	Date
Helen Smith	20 September 2011

Authorised on behalf of the Environment Agency

Schedule 1 - Site plan

This is the plan referred to in the standard rules SR2010No12

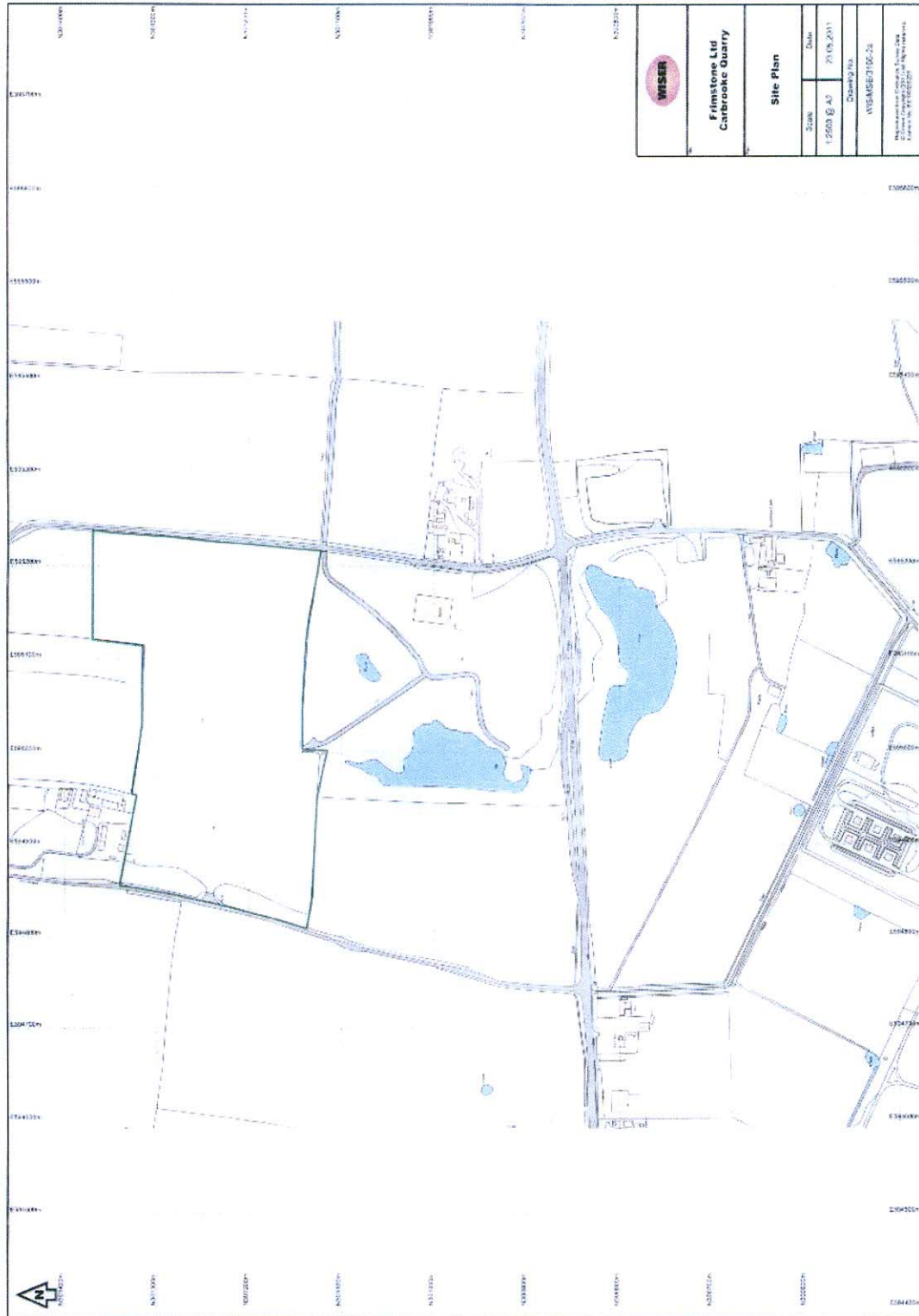

© Crown Copyright. All rights reserved. Environment Agency, 100026380, 2011.



Standard rules SR2010No12

Treatment of waste to produce soil, soil substitutes and aggregate

Introductory note

This introductory note does not form part of these standard rules.

When referred to in an environmental permit, these standard rules will allow the operator to store waste at a specified location and treat it to produce soil, soil substitutes and aggregate. Permitted wastes do not include hazardous wastes. The total quantity of waste that can be stored and subsequently treated at the site under these standard rules shall be no more than 75,000 tonnes per year. These standard rules do not permit the burning of any wastes, either in the open, inside buildings or in any form of incinerator.

The permitted activities shall not be carried out within 500 metres of a European Site¹, Ramsar site or a Site of Special Scientific Interest (SSSI) nor within a specified Air Quality Management Area (AQMA)². The permitted activities shall not be within:

- 10 metres of any watercourse;
- 50 metres from any spring or well, or from any borehole not used to supply water for domestic or food production purposes; and
- 250 metres from any well, spring or from any borehole used to supply water for domestic or food production purposes.

These standard rules do not allow any point source emission into surface waters or groundwater. However, under the emissions of substances not controlled by emission limits rule:

- Liquids may be discharged into a foul sewer subject to a consent issued by the local water company.
- Liquids may be taken off-site in a tanker for disposal or recovery.
- Clean surface water from roofs, or from areas of the site that are not being used in connection with storing and treating waste, may be discharged directly to surface waters, or to groundwater by seepage through the soil via a soakaway.

End of introductory note

¹ A candidate or Special Area of Conservation (cSAC or SAC) and proposed or Special Protection Area (pSPA or SPA) in England and Wales.

² An Air Quality Management Area within the meaning of the Environment Act 1995 which has been designated due to concerns about particulate matter in the form of PM10.

Rules

1 – Management

1.1 General management

- 1.1.1 The operator shall manage and operate the activities:
- (a) in accordance with a written management system that identifies and minimises risks of pollution, including those arising from operations, maintenance, accidents, incidents, non-conformances, closure and those drawn to the attention of the operator as a result of complaints; and
 - (b) using sufficient competent persons and resources.
- 1.1.2 Records demonstrating compliance with rule 1.1.1 shall be maintained.
- 1.1.3 Any person having duties that are or may be affected by the matters set out in these standard rules shall have convenient access to a copy of them kept at or near the place where those duties are carried out.
- 1.1.4 The operator shall comply with the requirements of an approved competence scheme.

2 – Operations

2.1 Permitted activities

- 2.1.1 The operator is only authorised to carry out the operations specified in table 2.1 below (“the activities”).

Table 2.1 Activities	
Description of activities	Limits of activities
R13: Storage of wastes pending the operations numbered R3 and R5.	Treatment of wastes listed in table 2.3 consisting only of sorting, separation, screening, crushing and blending of waste for recovery as a soil, soil substitute or aggregate.
R3: recycling or reclamation of organic substances which are not used as solvents.	Secure storage of wastes listed in table 2.3 pending treatment.
R5: Recycling or reclamation of other inorganic materials.	Storage of wastes listed in table 3.1 shall not exceed 10,000 tonnes in total at any one time. All other wastes stored shall not exceed 40,000 tonnes in total at any one time. No more than 75,000 tonnes of waste shall be treated per year.

